



KABELBAUM BELEUCHTUNG STOSZSTANGE
CABLE HARNESS BUMPER LIGHTING

BILDТАFEL
PICTORIAL DISPLAY

08.96

2223157-ETL A

1/1

GMK 5160
BE 505
G 801

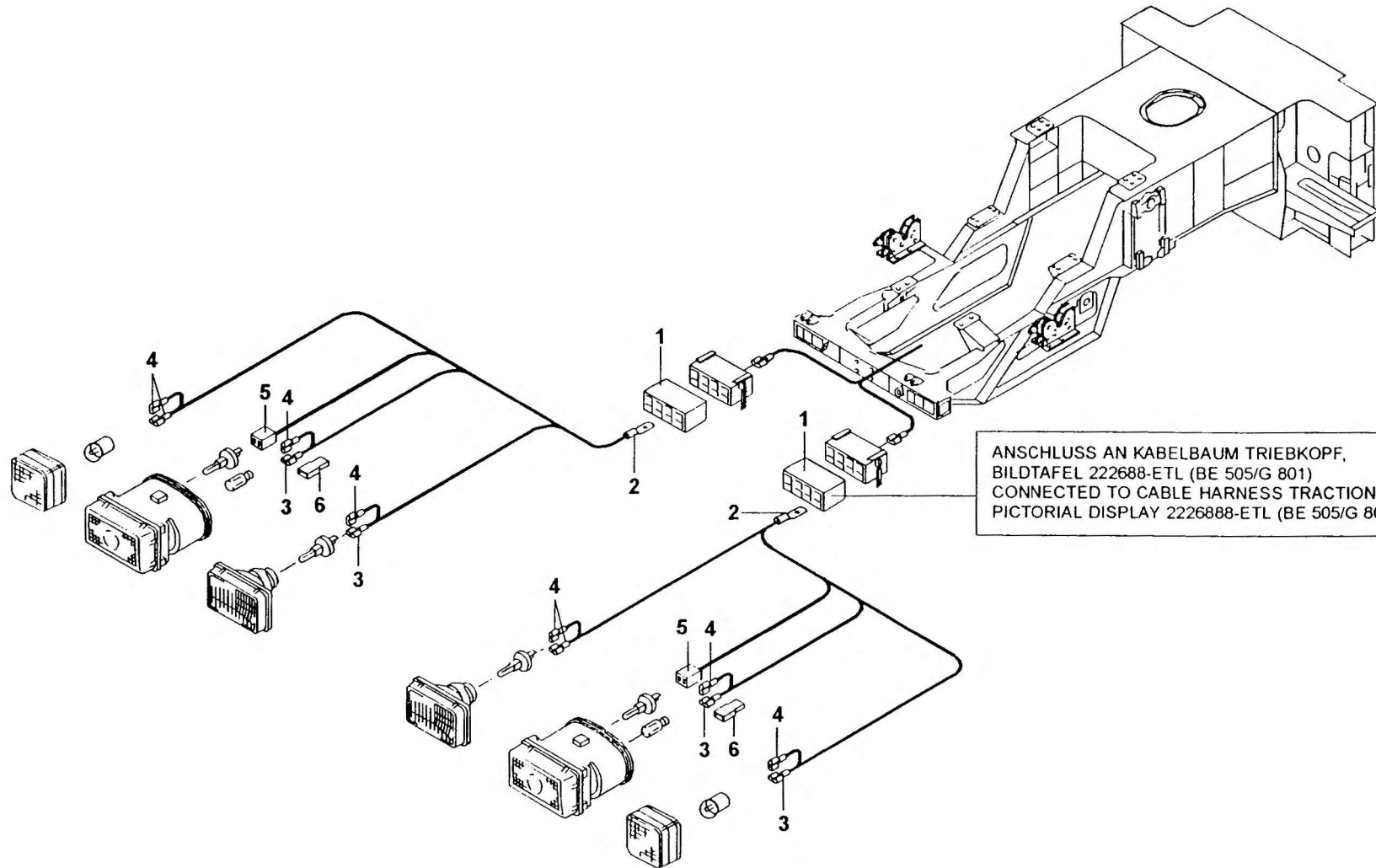

ANSCHLUSS AN KABELBAUM TRIEBKOPF,
BILDТАFEL 222688-ETL (BE 505/G 801)
CONNECTED TO CABLE HARNESS TRACTION UNIT,
PICTORIAL DISPLAY 2226888-ETL (BE 505/G 801)